



FM/USB/✕



GL -1790ABCD

Steam Bathroom (GS163)

The products are made according to ISO-9001 and the standard for electrician safety
 ★ Noted : The instructions are only for your reference. Please contact supplier
 for further information.

Manual

Casual Sanitary Wares

Dear user,

Thank you for your choosing GL series of computerized steaming bathroom, which are controlled by modern full function computer and using beautiful bronze metal parts. It sources from personality and unique for people.

Please read carefully this consumer manual before installation and operation to ensure that you can use this product safely.

Warning:

1.The electrical installation of this product must be made by qualified electrician.

2.The local electrical parameters must be accord with electric parameters of this product.

3.This product must be grounded properly and tested.

4.There is no parts of the computer control which can be repaired by user themselves, do not unpack the computer control yourselves if the electrical parts of this product do not work. You should inform the dealer to check and repair it. Our Company would not be liable for the electrical parts otherwise user unpack the computer control themselves.

5.This manual is owned by end user.

Contents

Steaming Bathroom Features and Parameters	1
Installation	2-9
Appurtenance: Aprons installation	10
Operation	11-17
Caution.....	18
Maintenance.....	19-20

6. Trouble shooting

Symptoms	Probable Causes	Recommended Action
No power to the steaming bathroom	①. General power plug connects loose to the electricity outlet or disconnected wiring. ②. GFCI trips.	①. Connect the plug to the electrical outlet properly or check, repair, replace the cord. ②. Check if there is creepage on the circuit, press the resume button on the GFCI.
The control system shuts down automatically	①. Control connects loose to the electrical outlet. ②. Temperature detector does not work.	①. Plug into the electrical outlet tightly and fasten the screws on the ends of the plug. ②. Replace the temperature detector.
The control LCD non-display	①. No power to the control panel. ②. Fuse of the control is burn-out.	①. Check and connect the control panel to the control properly. ②. Replace the fuse.
Steaming generator does not work	①. Steaming generator disconnects to the control. ②. Thermal tube does not work. ③. No water to the steaming generator or not enough. ④. Steam outlet is blocked. ⑤. Setting temperature is lower than temperature indoor. ⑥. Setting time runs out. ⑦. Thermal break shut down.	①. Check and plug in, Plug the connector tightly. ②. Replace it. ③. Check the piping and electromagnetic valve, remove obstruction or replace the valve. ④. Remove obstruction. ⑤. Reset the temperature or wait for the indoor temperature lower down. ⑥. Restart the system. ⑦. Resume the thermal break or replace it.
Steaming generator can not drain automatically	①. Drainage electromagnetic valve disconnects. ②. Drainage electromagnetic valve does not work.	①. Reconnect cord of electromagnetic valve. ②. Replace electromagnetic valve.
No lighting	①. Lamp or rectifier does not work. ②. Wire disconnects. ③. the control box no power output.	①. Check the lamp or rectifier, repair or replace. ②. Check and reconnect wiring. ③. Check power output of the control box.
Exhaust fan does not work	①. Exhaust fan does not work. ②. Exhaust fan disconnects.	①. Repair or replace exhaust fan. ②. Reconnect wiring.
Telephone receiver is not available	①. Telephone receiver disconnects to the telephone indoor. ②. Telephone indoor is of anti-theft-dialing lock.	①. Reconnect telephone wiring. ②. Turn off the anti-theft-dialing lock.
Radio effect is not good enough	①. Antenna is not spread. ②. Antenna position is not proper.	①. Spread the antenna. ②. Adjust antenna position.
Remote control does not work	①. Capacity of battery is too low. ②. Battery install wrong direction.. ③. Remote control is not available..	①. Replace battery.. ②. Install battery properly. ③. Replace the remote control..

Notice:①. Call dealer or qualified electrician for maintenance when meeting problems.
②. Must not replace, put on or take off the electrical parts when checking problems by user themselves.

Steaming Bathroom Feature and Parameters

1. Model, specification and function of steaming shower module

Model: GL-1790A (size: 1500×900×2200mm)

Model: GL-1790B (size: 1600×900×2200mm)

Model: GL-1790C (size: 1700×900×2200mm)

Model: GL-1790D (size: 1800×900×2200mm)

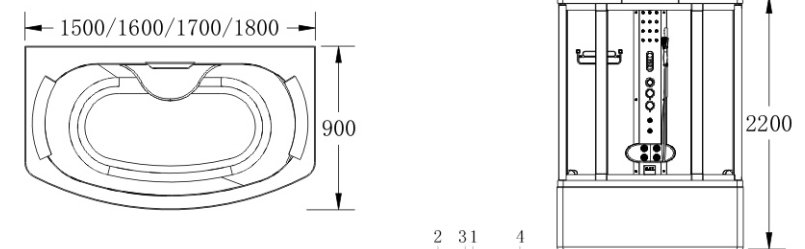

1. Light
2. Ventilation Fan
3. luxurious top shower
4. Speaker
5. Shelf
6. Ozone Disinfection
7. Flexible Shower
8. Computer control
9. Shower & Water inlet switch
10. Water inlet valve
11. Water Temp Adjustor
12. Steam Export
13. Luxurious Seat
14. Bottom massage tub
15. Atomization Massage
16. Head Rest
17. The waist by
18. Chandeliers



2. Water and electric technical parameters of computerized steaming bathroom.

Power Parameters				Water Supply Parameters			Diameter of the Pipe Joint	
Voltage	Frequency	Control Voltage	Power	Water Supply Pressure	Operative Water Pressure	Capacity of Overflow	Cool & Hot Water Supply	Drainage
AC380V /AC220V /AC110V	50HZ /60HZ	DC12V	Steamer	≥0.2MPa	0.2-0.4MPa	8-10L/min	φ 15	φ 40
			Hydromassage pump					
			2.8kw /3.5kw					
			0.75kw /1.1kw					

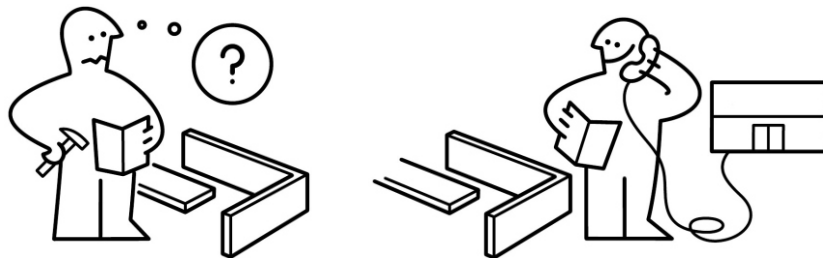
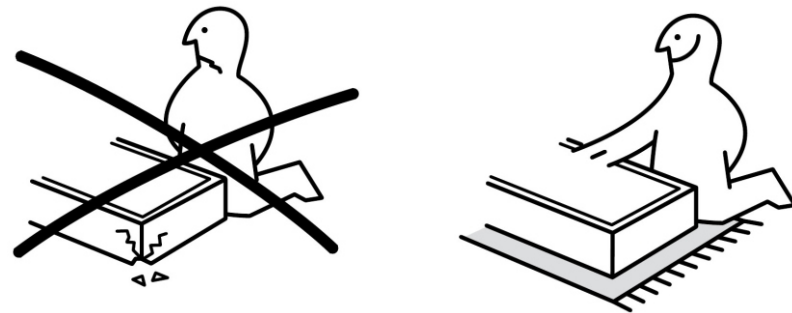
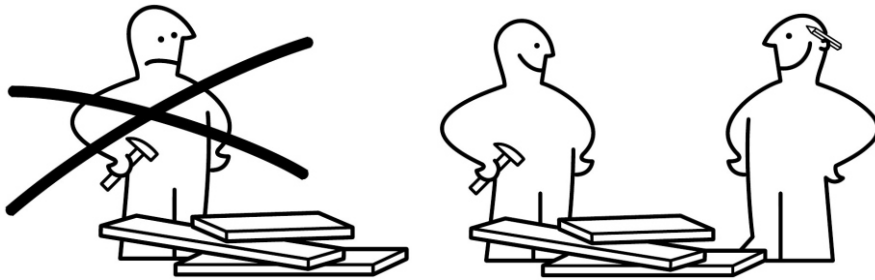

Maintenance

1. Keep the acryl surface of the shower panel from crashing by a sharp edge. If the surface is crashed or there is some blot which can not be removed by scrub, using #1500 sand paper to polish it and apply some toothpaste on a soft cloth to wipe it.
2. Using special cleanser to clean-up the shower panel. The cleanser contain no such organic solvents as acid, alkali, ketone and aldehyde.
3. Need not polish the plating parts of the shower panel to prevent from affecting the brightness of the surface. Keep benzine and acid (such as sealant) away from the plating parts avoid eroding when being in installation.
4. Shut down the water and electrical supply if the shower panel is not in operation for a long time. Keep it in a dry and ventilated circumstance and far away from volatile chemicals.
5. Clean-up the filter at the joint of the water pipe to ensure the fluent flowing.

Caution

- Don't disconnect the appliance with wet hands;
- Don't use or stop the use if the appliance is damaged, especially the supply cord and the case;
- Parts containing live parts, except parts supplied with safety extra-low voltage not exceeding 12V, must be inaccessible to a person in the bath;
- Earthed appliances must be permanently connected to fixed wiring;
- Parts incorporating electrical components, except remote control devices, must be located or fixed so that they cannot fall into the bath;
- The appliance should be supplied through a residual current device (RCD) having a rated residual operating current not exceeding 30mA;
- The built-in battery contains substances which may be harmful to the environment. When you discard your remote controller in due course, please remove the battery and hand it in separately at an officially assigned collection point.

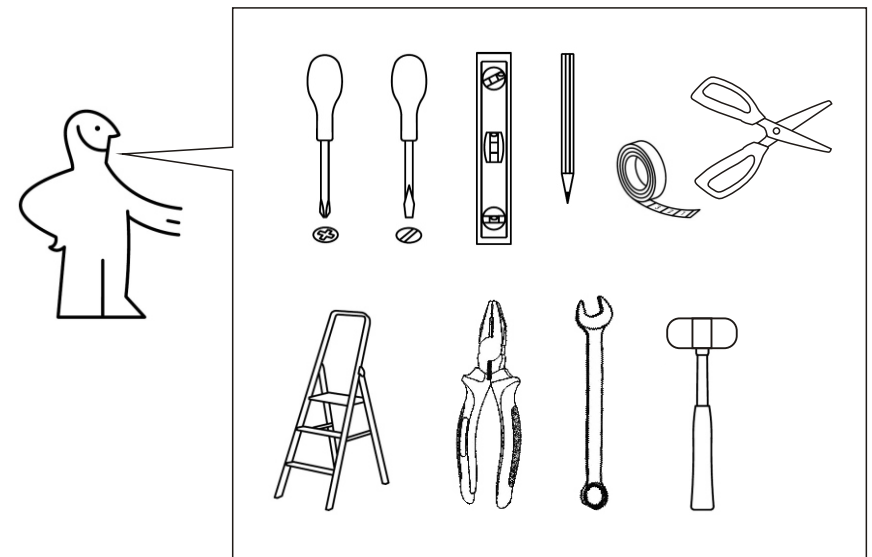
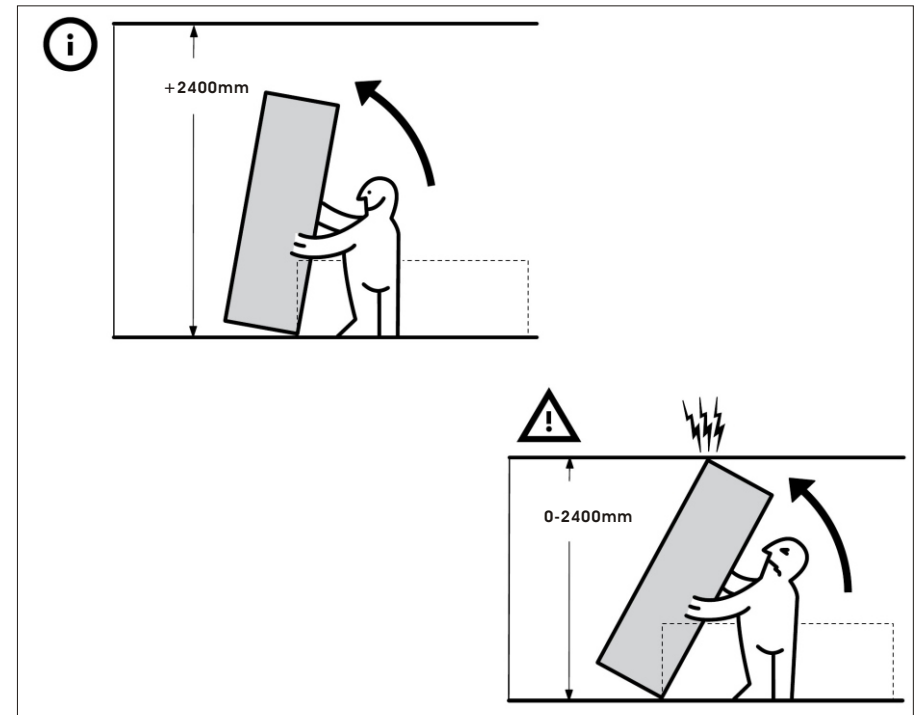

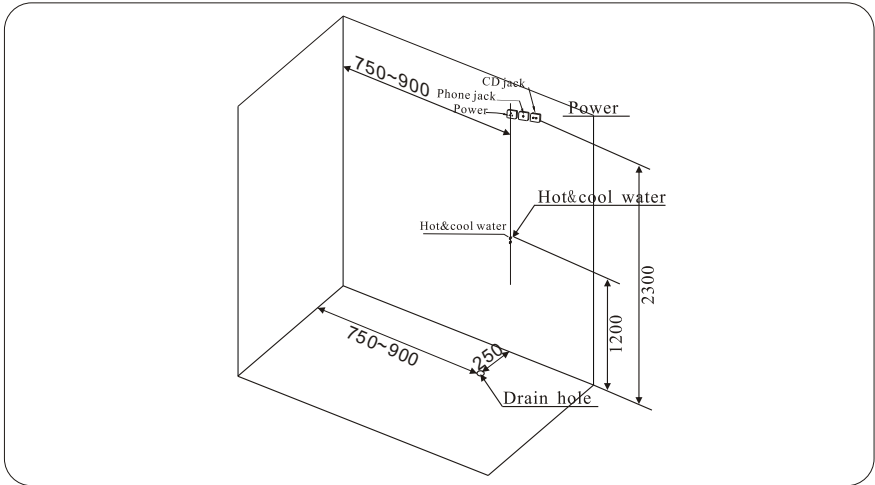
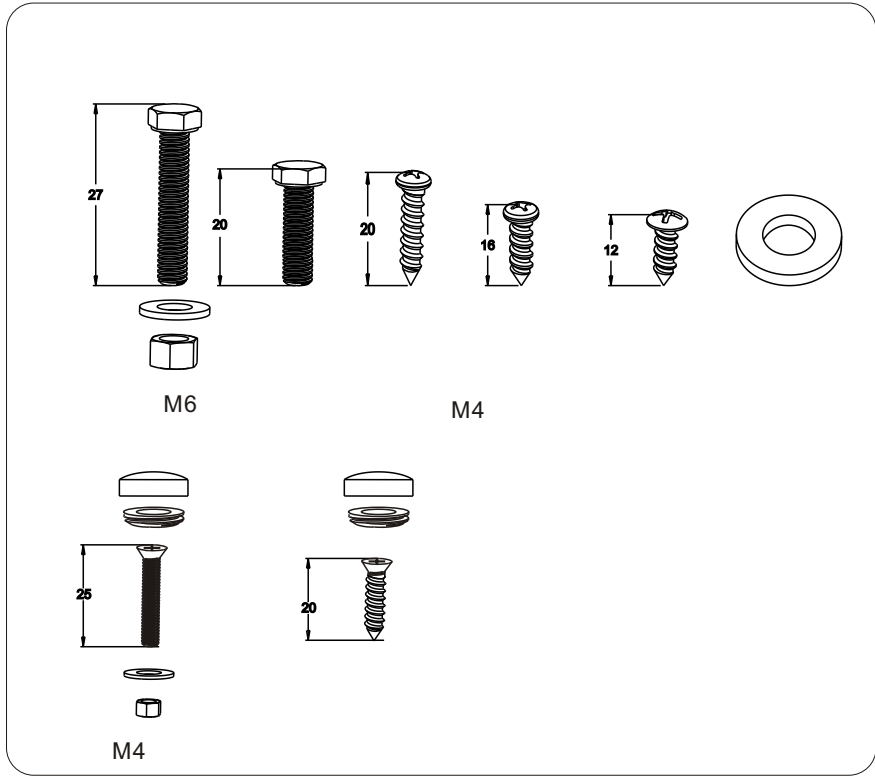

Operation

1. Operation of variety flow valve

Turn on the general valve of water supply, pull up the wrench valve to make the water overflow and turn it to adjust the water temperature. when the water temperature is steady, turn the variety flow valve to select function according to your desire including foot massage, overflow from portable shower head, fixed top shower head, faucet of the bathtub.

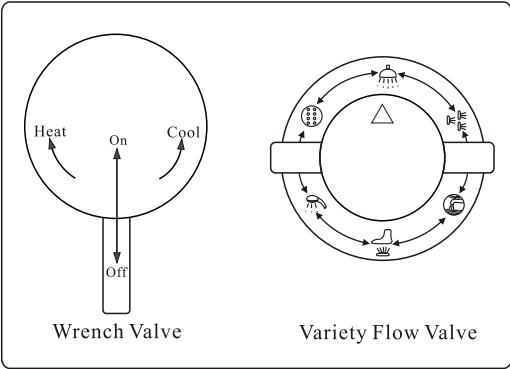

2. Operation of whirlpool massage.(this function is not included if the bathroom without whirlpool bathtub.)

Push air break switch to turn on the water pump for whirlpool massage, you can turn air adjustor for comfortable water pressure. Push air break switch again turn off the pump.(air break switch and air adjustor are all installed on the bathtub surface).

3. Operation of control panel and remote control (GL-05A control system)

3.1 Connect the plug to the electrical outlet, the bathroom collocates a plug protected by Ground-Fault-Interrupter(GFCI), press power button, the system would be standby, the indicator light display green, make sure the GFCI is effective by pressing the test button before using the bathroom.

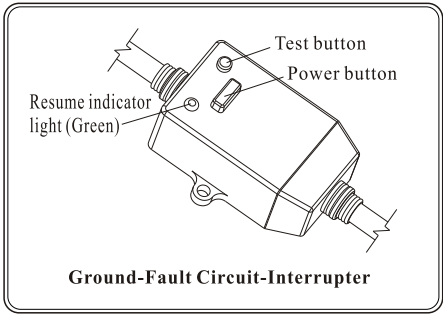

Appurtenance: Aprons installation

- Follow diagram 5 to insert aprons into pontes crevice between stretch board and tub edge
(notice : properly incline apron to ensure insert go fluently)

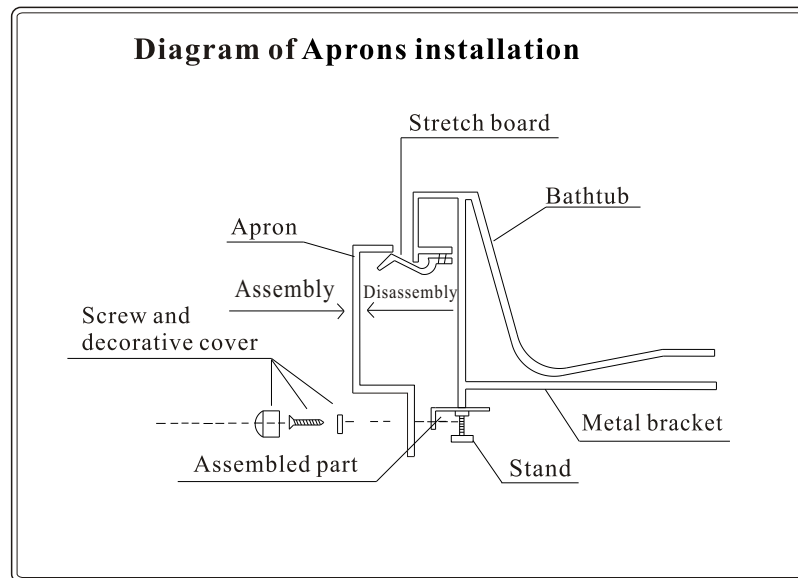

- Regulate aprons installation location, with lock nuts to tighten aprons to fastener, cover fastener with decorative nuts.
- Put tub on prepared location , insert drainpipe into prepared waterspout, notice : keep inlet depth less than 10cm(if water spout faraway from location , you can lengthen the hose with same diametral hose , but please ensure kerf with plastic sealed against any leakage .)
- Reinstall the apron according to the above procedures in an inverse turn.

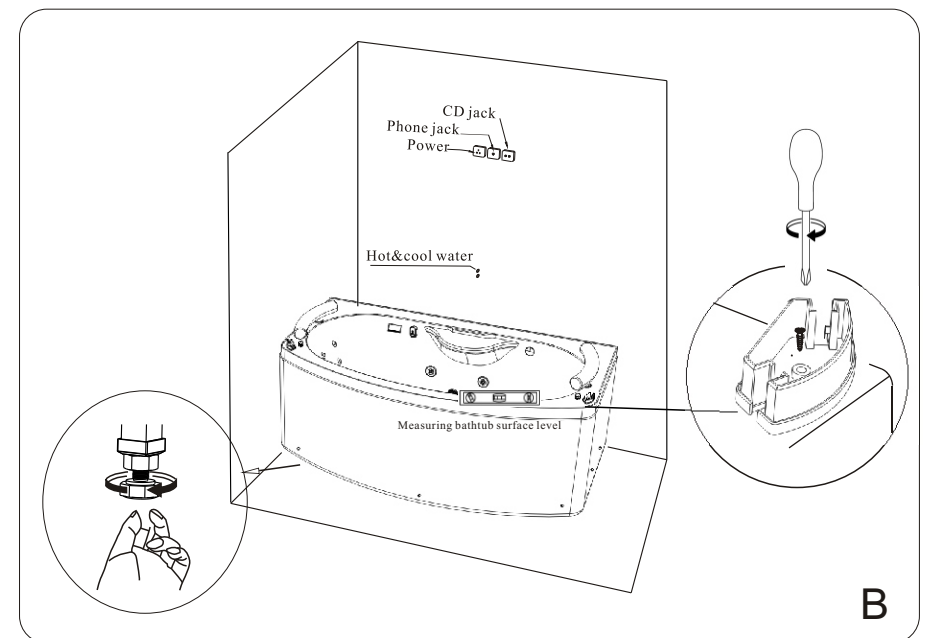
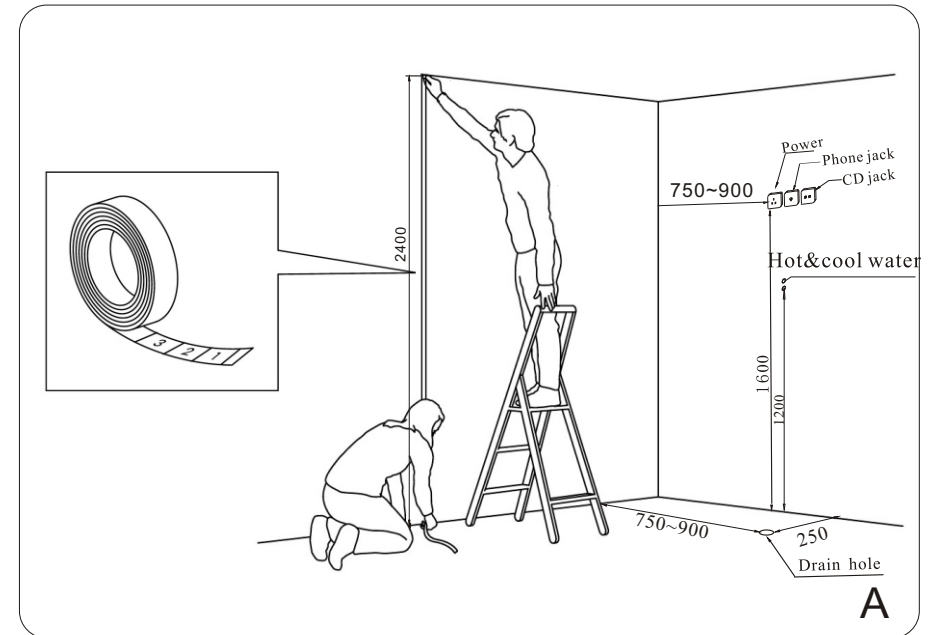

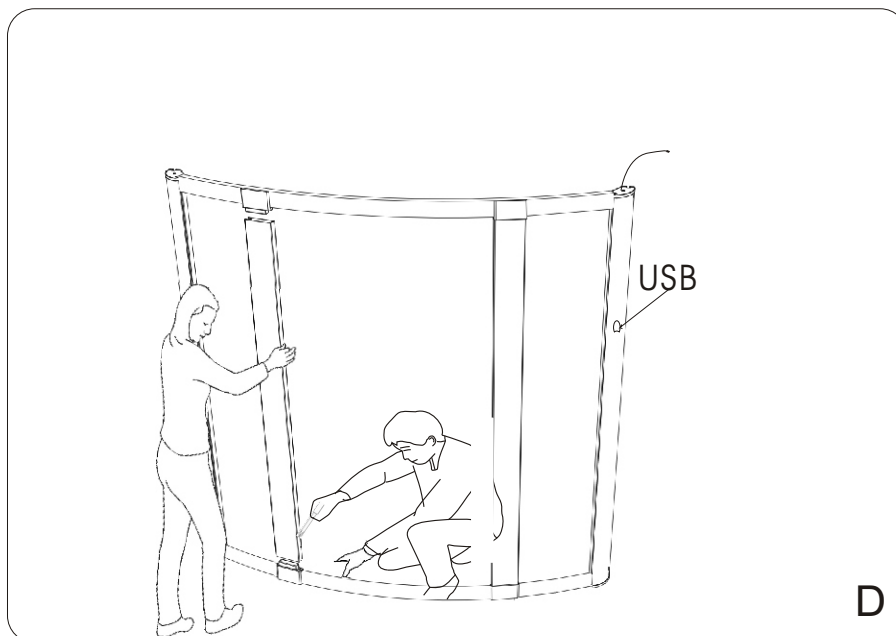
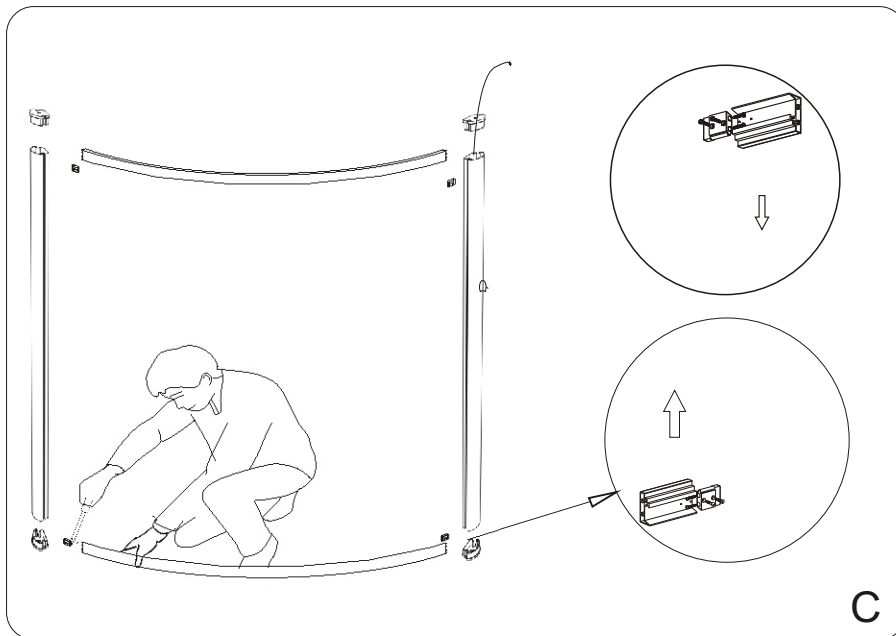

5. Using medication steaming

Diagram of Place the medication

For steaming bathroom with bathtub

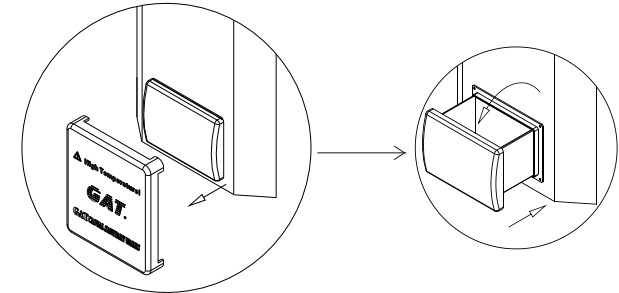

For steaming bathroom without bathtub

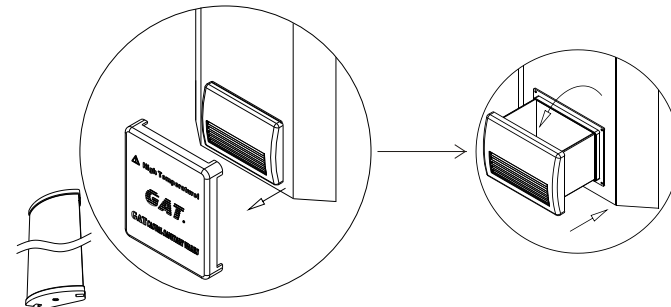

5. Operation of the Thermal Faucet(Optional)

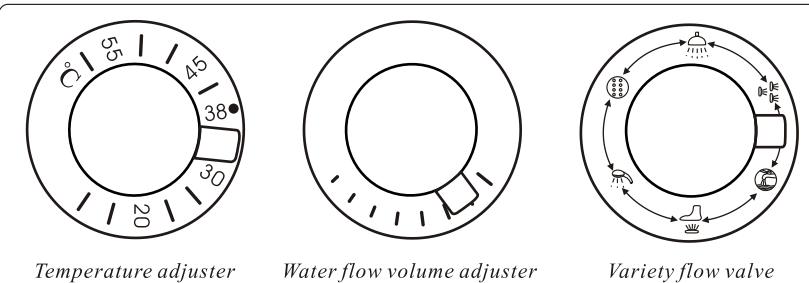

Diagram of Control panel for thermal faucet

Error Code	Error Description	Handle Method
E2	Steam Generator too hot	Check Steam Generator
E3	Overtime of Steaming water inlet	Check water inlet source or water inlet electromagnetic valve
E4	Temperature detector short out	Check detector
E5	Open circuit of Temperature detector	Check detector wire
E6	Bluetooth disconnection	Check Bluetooth connection

4、Technical Parameters

Operate condition and Characteristic

Rated Voltage	AC220V	Rated Frequency	50Hz~60Hz
Rated Current	13.6A	Rated Power	3050W
Insulation Resistance	>20M	Leak Current	Meet products inspection standard
Waterproofing Grade	IPX5	Leak Protection Current	(15~30)mA

Parameters of Load Device

Load Grade	Load Rated Voltage	Load Rated Frequency	Load Rated Power	Quantity
Steam Generator	Ac220V	50Hz/60Hz	3W	1
Ceiling Light	Dc12V	-	5W	1
Fan	Dc12V	-	3W	1
Electromagnetic Valve	Dc12V	-	5W	2
Speaker	-	-	8Ω /10W	1
Ozone Disinfection	Dc12V/Ac12V	-	5W	1
Background Lamp	Dc12V	-	10W	1

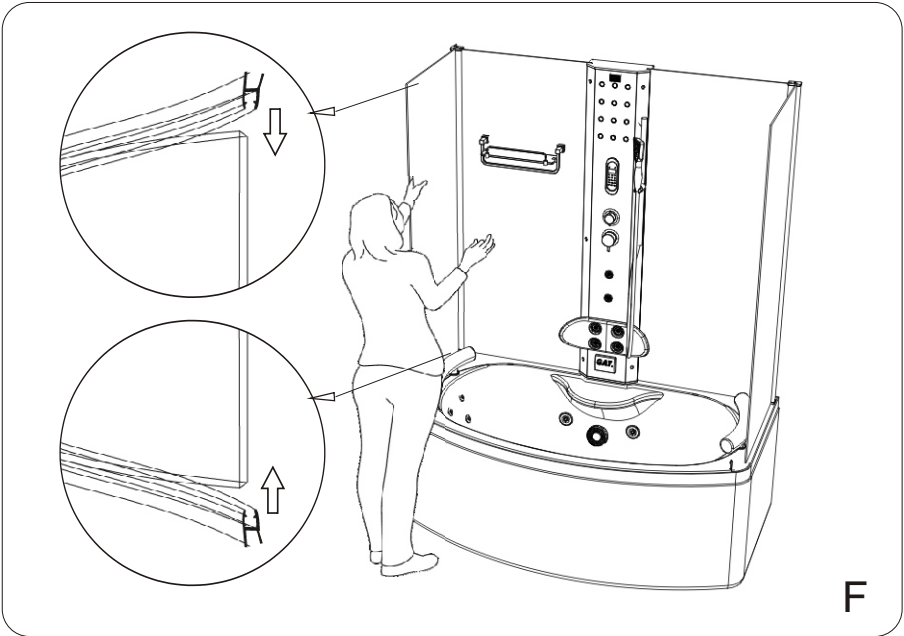
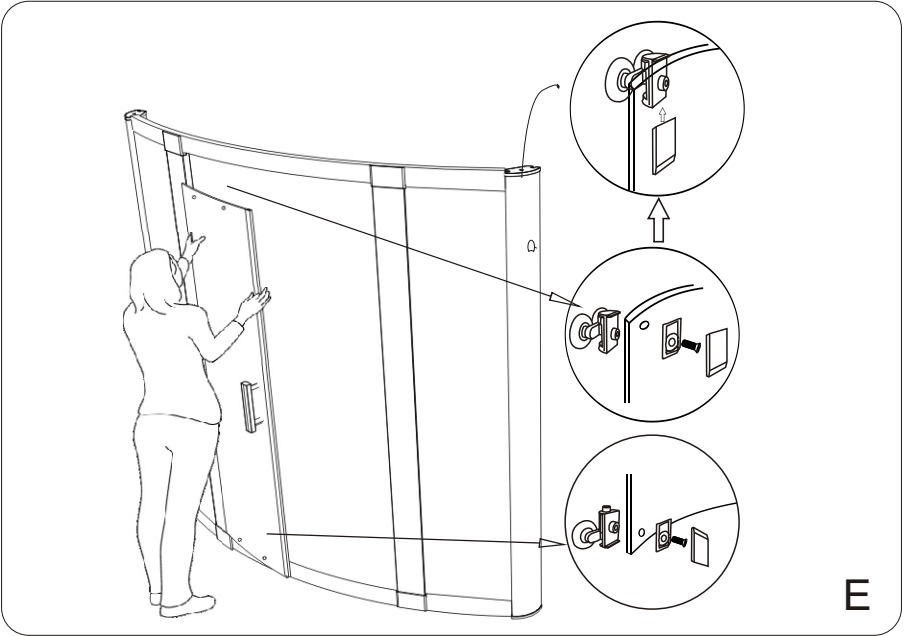

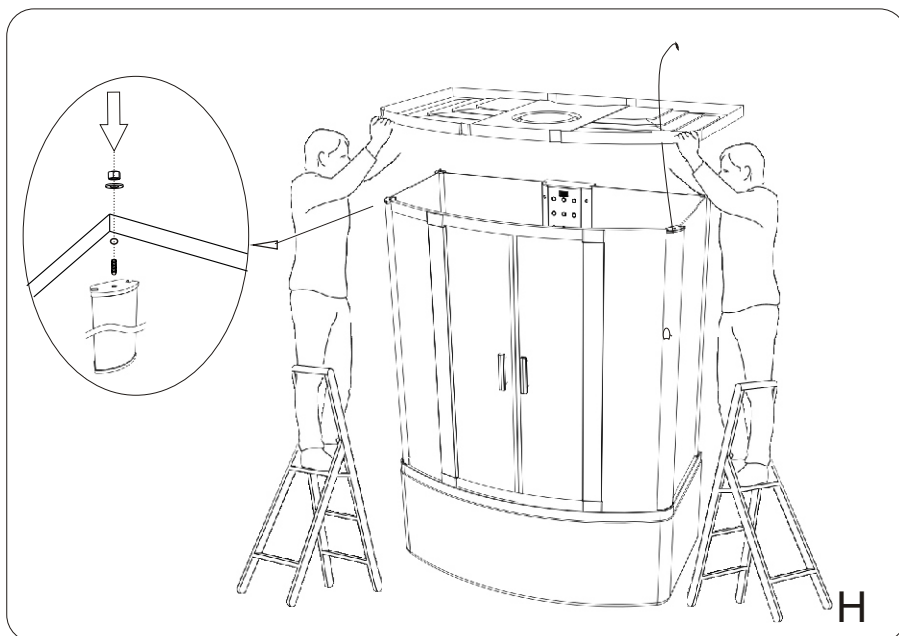
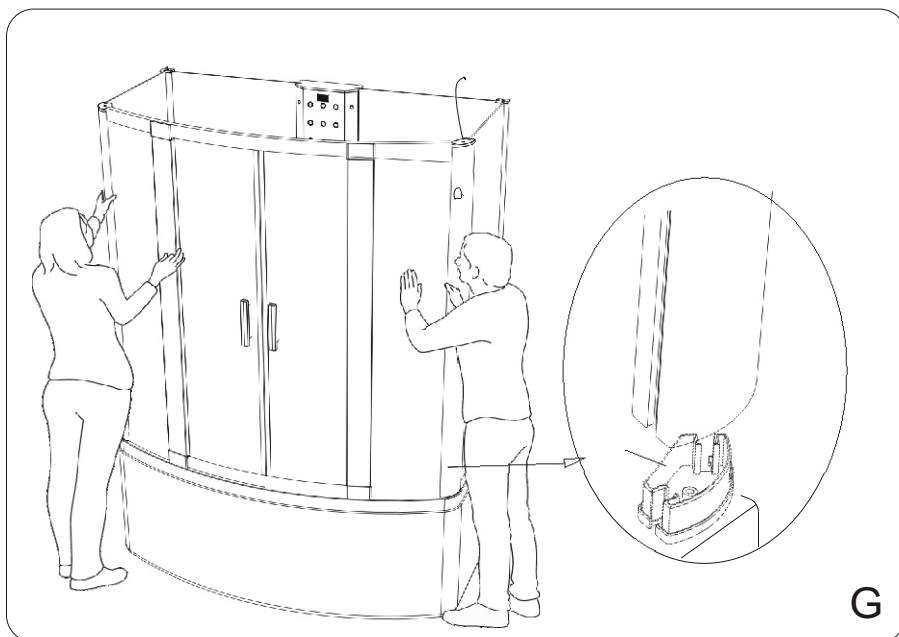

(6)、Degree Celsius & Fahrenheit Degree display switch

On system working state, press 2 seconds key for change Degree Celsius & Fahrenheit Degree, the LCD display will show the revised temperature immediately, and the system also automatic the save the temperature display usage.

(7)、Telephone Receiving Function

When system on, if there is coming calls, the control panel will show **TEL** means calling, meanwhile the speaker will play ringtone. Touch can answer the call, touch can refuse or end the call.

PS: Only when system connects with Bluetooth Function can realize this function.

(8)、Bluetooth Music Playing Function

1. Bluetooth music playing function on: when the system on and also connects Bluetooth function, touch can switch radio function into Bluetooth music playing function. Retouch the key will turn off Bluetooth or radio function.
2. Skipping music: touch can skip music, it will show “bt”, then choose music by turning + or - .
3. Volume regulation: when Bluetooth in general state, touch can get into regulation state, the volume ranges from 0~15, control panel shows **db** when regulating.
4. Turn on Bluetooth music playing function, if disconnect with mobile phone, the control panel will show error code “E6”.
5. If system off, the Bluetooth function will be off automatically. Turn on system again requires reconnect Bluetooth via mobile phone, meanwhile turn on music playing function of mobile phone, the system can get into Bluetooth music playing function. After connection we can control the Bluetooth function.
6. USB: Press the key “”, the screen will show “USB”, enter the USB flash disk into the USB connector, then the music will play automatically.

(9)、Ozone Disinfection

5 minutes after system off, the Ozone Disinfection will be on for 10 minutes and then off automatically. Turn on system when Ozone Disinfection operating, Disinfection function will be off automatically. (S163BT-C has this function)

(10)、Error Code

The system can test automatically when it does not work well, and shows error codes on the control panel.

Open the rubber plug
Enter the U-disk as
shown in the figure

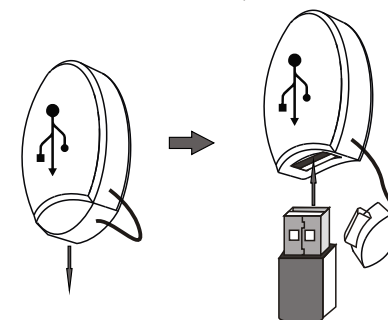

3.Operation:

(1)、Power on/off

1 Power on:

The system will make a sound -"toot" while power on.

2. Starting up

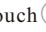
When holding state, touch  key for starting up. The LCD display shows the indoor's temperature, such like **25 °C**, and automatic turn on the top lamp, and automatic setting 60 min for system turn on.

3. Power off:

(1)、Touching panel  key or setting 60 min for turn off , turn off all working function and return to stand by. Draining automatic 2 min while 2 min later after turn off.

(2)、Light function:

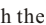

In working state, touched  key to turn on/off the lamp function . Sequence: top lamp light → background lamp & top lamp light → background lamp & top lamp turn off(P.S.: background function can be optioned)

(3)、Fan function:

On working state, touch the  key for turn on/off the fan function and indicator light on.

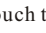
(4)、Radio function:

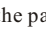
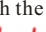
1) On working state, touch the  key for turning on/off. Turn on radio function will see the frequency on the LCD display, such like **102.7**

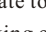
2) Touch the  key of the panel for adjusting frequency, **Mhz** icon will flash and then touch the  or  for adjusting, and touch the  key for saving the frequency, the LCD display show the current frequency, such like **3ch**.

3) While on working state to touch  key for change the frequency, from 1-8.

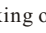
4) When the radio working or touch the  key to adjust the volume, from 0-15, and the LCD display will show such as **1db**

(5)、Steam function:

1) When the system turn on state, touch the  key for turn on/off the steam function. While turn on the steam light indicator light. Automatic setting 45 min working while turn on the steam function and steam temperature in 45 °C.

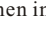
2) While turn on the steam function and touch the  key for adjusting. If the **Mhz** icon flash on the LCD display, such as **45** then into timing setting, the figure on the LCD display is the balance steam timing. Touch again the  key to steam temperature setting, at this time the LCD display will flash the **°C** icon, such as **36 °C**, the figure is the temperature.

P.S: Steam temperature setting form 25-60 Degrees Celsius(or 77-140 Fahrenheit Degree), Setting timing 1-50 min.

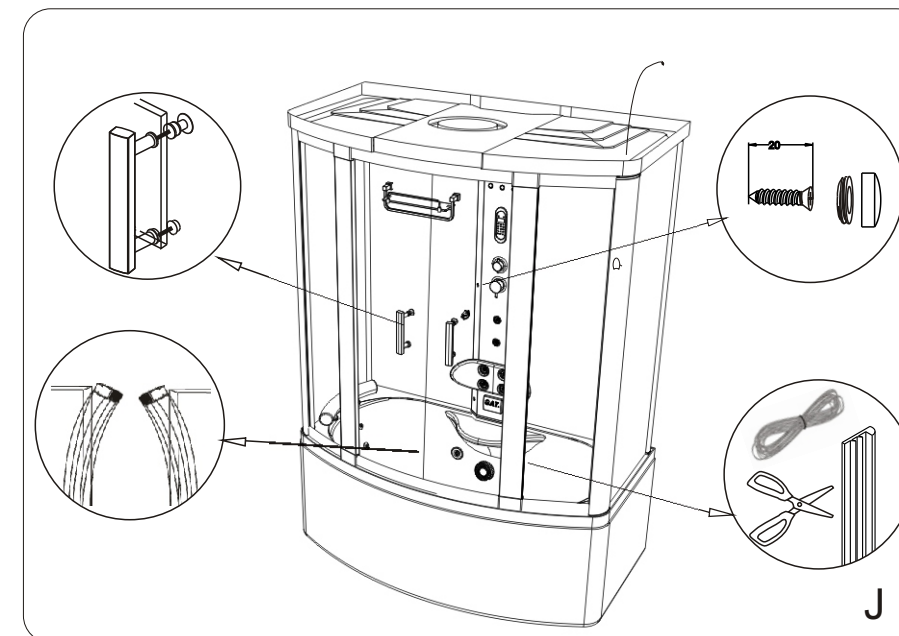
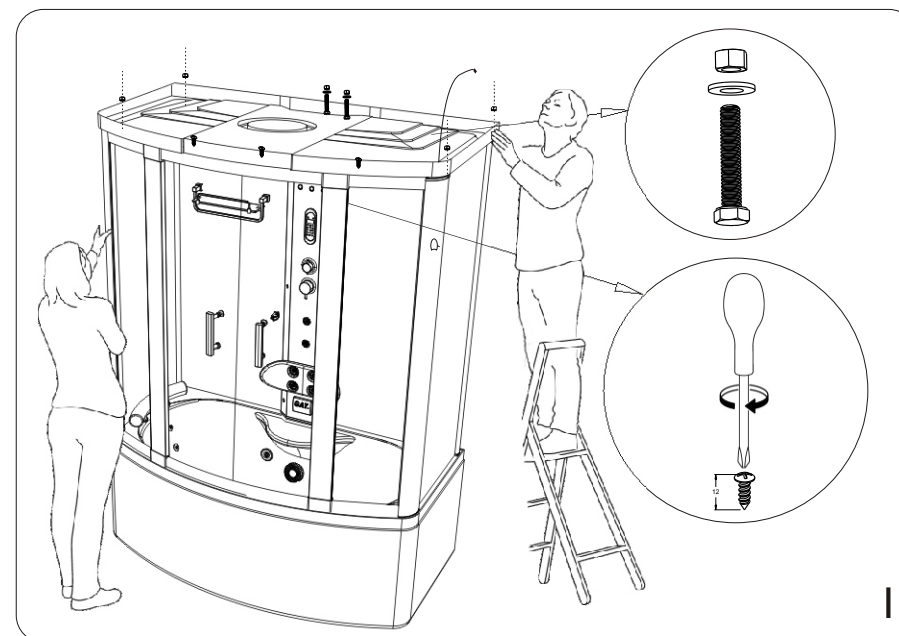

4. Electrical connection

- ▶▶ Properly joint the cord according to the marks, contain: top lamp, background lamp, speaker, exhaust fan, ozone disinfection and steamer.
- ▶▶ Connect the grounded cord of the bathroom to the protected indoor grounded system and test it, It is forbidden to connect the grounded cord onto water and gas pipe.

5. Steamer connection

- ▶▶ Connect properly according to the joint marks on the steaming pipe, steamer and inlet through the drill hole on the bathtub.
- ▶▶ Connect the steamer grounded cord to the protected indoor grounded system, It is forbidden to connect the grounded cord onto water and gas pipe.
- ▶▶ The drain pipe of the steaming generator would be with high temperature when it works, make sure to connect it into the waterspout on the floor.(The run-in length should be over 10cm).

6. Water connection

- ▶▶ Connect the top shower from variety flow valve(caution the marks on the pipe end), then take the aluminium alloy board into bathroom, connect all functions refer to the marks on the pipe end.
- ▶▶ Connect the hot&cool water supply hose to indoor prepared tie-in, caution which is hot water or cool water.

Notice: To cut off the water supply easily after finishing your bath anytime, please place a general water valve between the supply outlet and bathroom inlet on a easy-operated place.

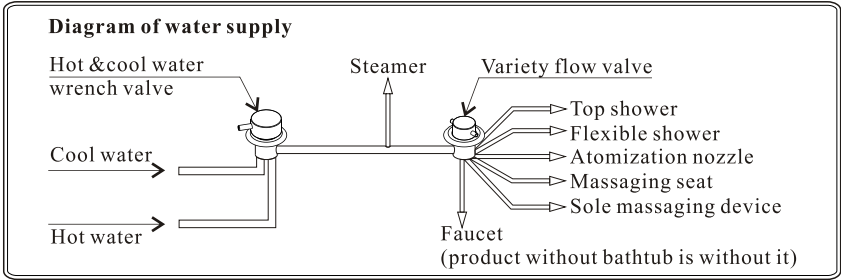

Operation procedure for control
Diagram of Control Panel

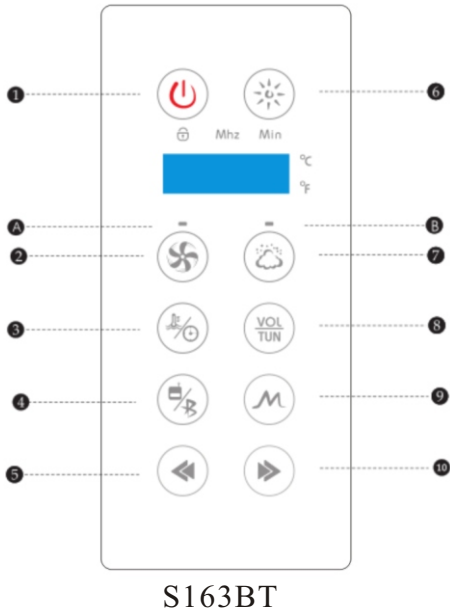

1. Warning:

- 1.This panel is used capacitive touch type button, when selecting the place for panel installation, do not towards the nozzle/shower nozzle, otherwise it will lead to mal-operation or panel locking.
- 2.The best range of touch on each function key of the panel location area.
- 3.This panel processing was optimized by using the water proof, when mal-operation(touch two or more over two keys in the same time), system does not respond, and will recover after 1 second.
- 4.When the panel is locking, touch the panel, system does not respond and at the same time the icon flashing, to press key system to lift the blockade, while the icon stop flashing, all function keys return to normal.
- 5.Every time press the function key, the system will make a sound-“toot”.

2. Function instruction:

- | | |
|--------------------------------------|------------------|
| 1.Floodlight function | 2.Fan function |
| 3.Steam function | 4.Radio function |
| 5.Phone reception function | 6.DTCs |
| 7.Celsius,Fahrenheit switch function | 8.Bluetooth |